

Quick-action connection - Male

Acetylene, Propane

Argon & Oxygen



Product features

- Quick-action connection according to EN561, ISO 7289.
- Safe interruption of gas flow through automatic gas shut-off when disconnecting.
- No mixing up by different coding of coupling pins.
- Prevents accidental disconnection.
- All metal components in brass 2,0401 / spring 1,4310.
- Push-system connection.

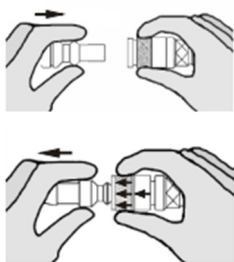

Safety elements of the GasiQ quick action connection:

- SV, Shut-off valve.

Maintenance:

- Connections are wearing parts and have to be tested by a qualified and authorised person (at least once per year)
- The tests have to be performed when the connections are connected as well as disconnected. Leakage test are to be performed with inert gas or air (free from oil and grease) or the operating gas.

Flowchart

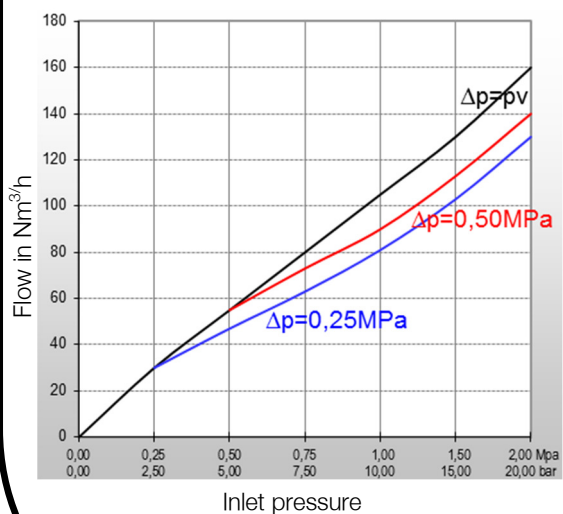
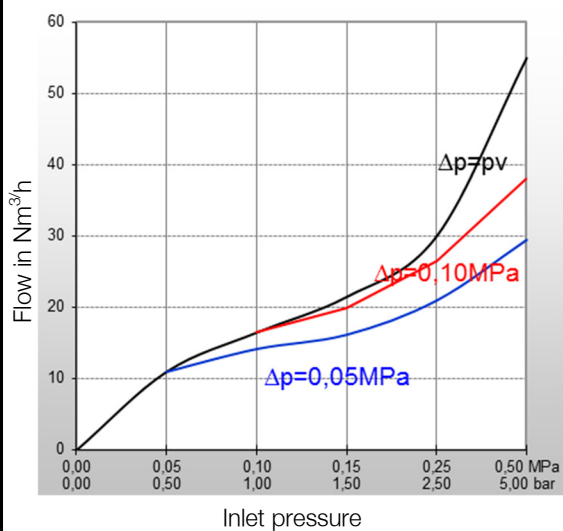
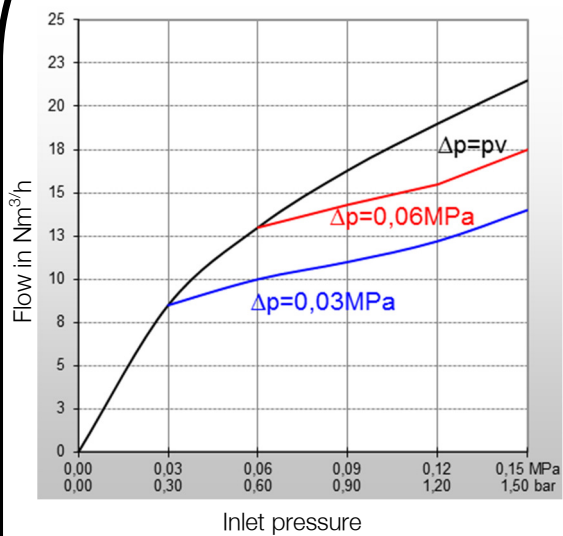

Flow rates [air]:

p_v = Primary pressure

p_h = Secondary pressure

Δp = Primary pressure minus Secondary pressure

Conversion Factors:

$0.1 \text{ MPa} = 1 \text{ bar} = 100 \text{ kPa} = 14.504 \text{ psi}$

$1 \text{ m}^3/\text{h} = 35.31 \text{ cu ft/h}$

Exampel:

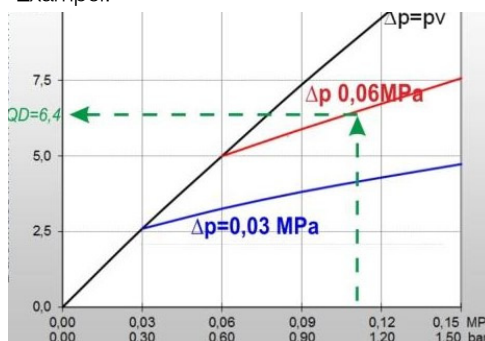

$$QG = QD \times F$$

$$QG \rightarrow A = 6.4 \times 1.2 = 7.68 \text{ m}^3/\text{h C}_2\text{H}_2$$

QG = flow / gas type

F = conversion factor

QD = flow / air

Technical data

Gas type: Acetylene / Propane / Oxygen / Argon

Working pressure:

Acetylene 0,15MPa / 1,5 bar

Propane 2,0MPa / 20 bar

Oxygen 2,0MPa / 20 bar

Argon 2,0MPa / 20 bar

Gas temperature: -20°C up to +70°C (Oxygen -20°C up to +60°C)

Ambient temperature: -20°C up to +70°C

Dimensions

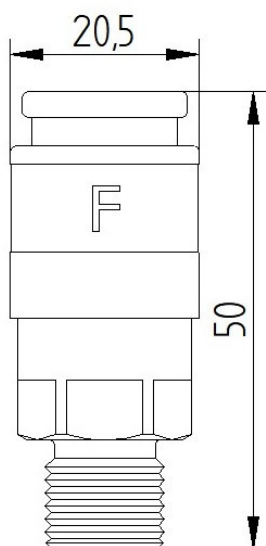

Quick-action connection F	Outlet
Oxygen	G3/8"
Argon	G3/8"
Acetylen/Propan	G3/8"L